

## Passive Anti-Theft System (PATS) Transceiver

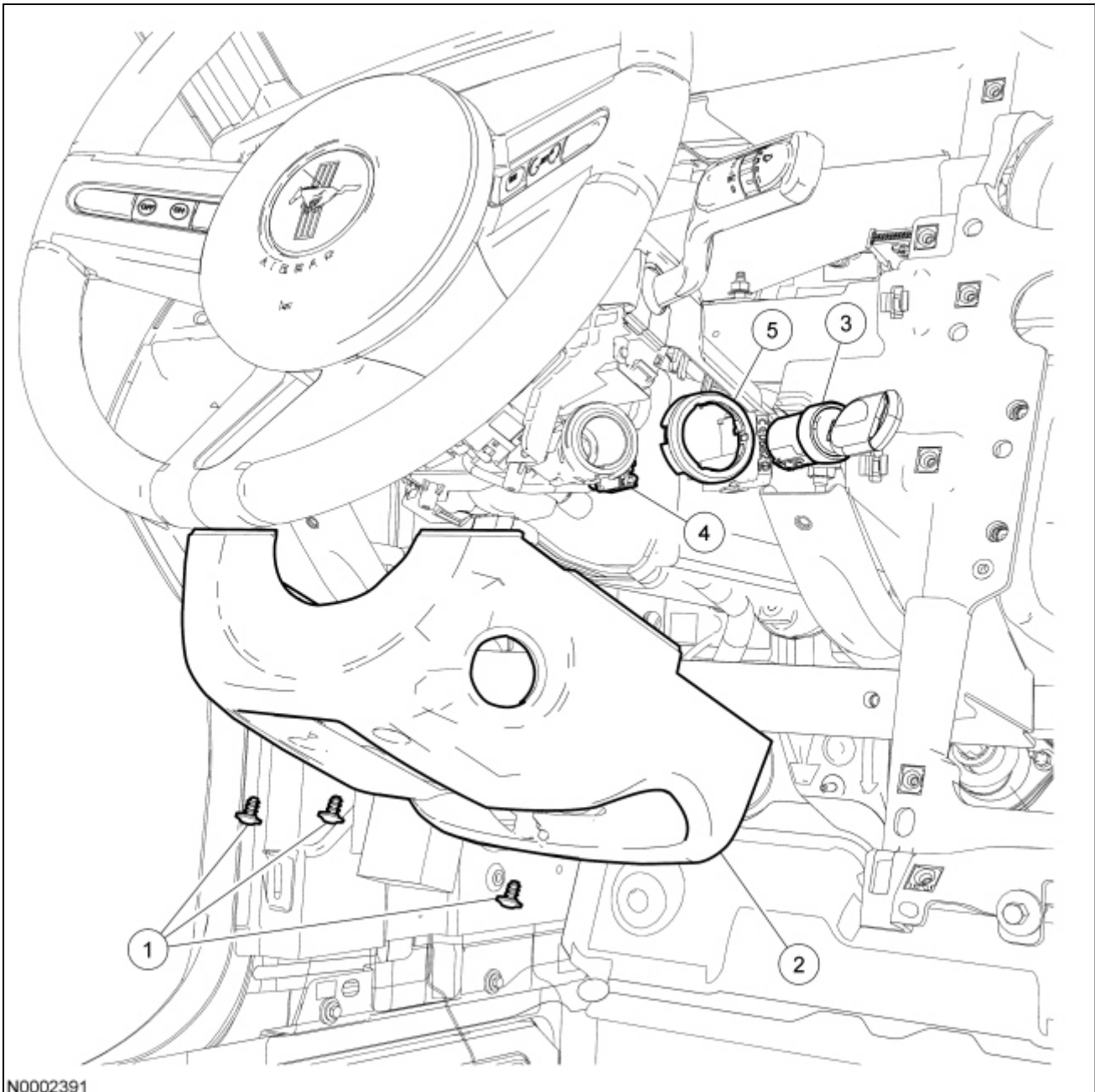

N0002391

Item	Part Number	Description
1	55929	Steering column shroud screws (3 required)
2	3K512	Lower steering column shroud
3	1153	Ignition lock cylinder
4	—	Passive Anti-Theft System (PATS) transceiver electrical connector (part of 14401)
5	15607	<a href="#">PATS</a> transceiver

### Removal and Installation

1. Remove the ignition lock cylinder. For additional information, refer to [Section 501-14](#).

2. Disconnect the Passive Anti-Theft System (PATS) transceiver electrical connector.
3. Release the clips and remove the PATS transceiver.
4. **NOTE:** Replacement of the PATS transceiver does not require the PATS keys to be programmed into the PCM again.

To install, reverse the removal procedure.

---